

Edward e Wallis

Berlin Prenzlauer Berg, 2. OG to rent

Object ID: CaB 165



Living area approx.: **76 m²** - Zimmer: **2**



Edward e Wallis

Object ID	CaB 165
Property Type	Apartment
Address	(Prenzlauer Berg) 10437 Berlin
Floor	2
Living area approx:	76 m ²
Landspace	883
Geschossflächenzahl	7000
Zimmer	2
Wohn-Schlafzimmer	2
Heating type	Central heating
Primary energy supplier	Gas
Year of construction	1910
Available from	29.05.2024
Available until	31.12.2099
Deposit	3,540.00 EUR 3.540,00
Flat rate rental	1,770.00 EUR





Objektbeschreibung

You find the spacious 76 sqm apartment on the second floor of an attractive historic building with an elegant staircase. There are two rooms, both with charming wooden floor. The generous main room consists of a nice area to sit and relax with a cosy sofabed and a dining area to enjoy your food, nicely positioned near the two big windows. The separate kitchen is very well equipped and contains an additional small dining area. The ample separate bedroom provides a comfortable double bed, a big cushy armchair near a bookcase with lots of space for books as well as a desk. The modern bathroom has a shower.





Location

Prenzlauer Berg is a very modern and laid-back neighborhood and very popular among young families and trendsetters. There are many pretty, colorful streets and squares: farmers markets, little boutiques, restaurants, cafés, bars and ice cream parlors invite for a stroll. To take a quick break from urban life you can go to the famous Mauerpark with its huge flea market on the weekends.

S-Bahn, subway nr. 2 and nr. 8, tram + bus,

ca. 8 mins to Alexanderplatz

ca. 15 mins to Hauptbahnhof

ca. 50 mins to the airport BER





Bild 1



Bild 2



Bild 3



Bild 4



Bild 5



Bild 6





Bild 7



Bild 8



Bild 9



Bild 10

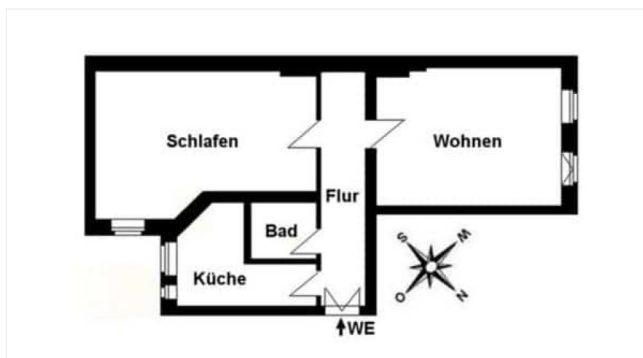

Bild 11

